

# KOENIG RESTRICTOR® SETTING TOOLS

## Series RE

**Material:**  
Tool Steel, Heat Treated,  
Hardness Approx. HRC 50

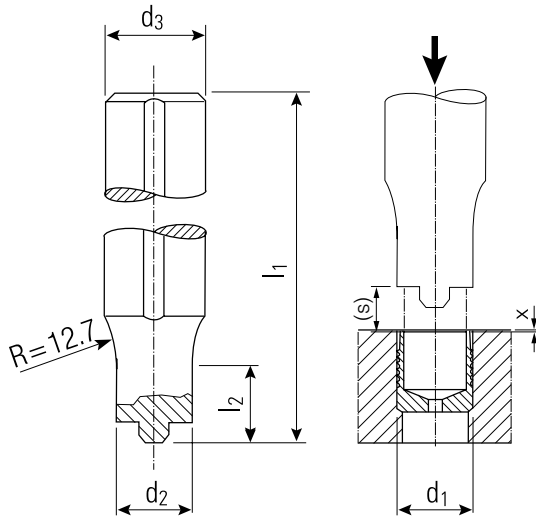

Part Number	d <sub>1</sub> Series RE	d <sub>3</sub> ±0.20	l <sub>1</sub>	d <sub>2</sub>	l <sub>2</sub>	(s) ~ Ref.	x ±0.30	Weight in gram/pcs.
HT-REM-040	RE-040-XXX	9.53	127	3.61	7.62	2.0	0.0	70
HT-REM-050	RE-050-XXX	9.53	127	4.78	12.70	2.7	0.0	70
HT-REM-060	RE-060-XXX	9.53	127	5.79	15.24	3.4	0.0	70
HT-REM-070	RE-070-XXX	9.53	127	6.78	20.32	4.1	0.0	70
HT-REM-080	RE-080-XXX	9.53	127	7.57	33.02	4.8	0.0	70
HT-REM-090	RE-090-XXX	12.70	127	8.36	38.10	5.5	0.0	70
HT-REM-100	RE-100-XXX	12.70	127	9.78	38.10	6.1	0.0	70

Dimensions in millimeters

### RECOMMENDED SETTING EQUIPMENT FOR SERIES RE

<b>EXPRESS 3000</b>	Hydropneumatic Table Press	See page 64 for more information
<b>EXPRESS 5000</b>	Hydropneumatic Table Press	See page 64 for more information