

KOENIG EXPANDER® SEALING PLUGS

Series LK 600



Material:

Sleeve: Stainless Steel, Special Oil Film Lubrication
Mandrel: Stainless Steel, Special Oil Film Lubrication

Important:

See installation instructions on page 81
Installation requirements on page 73

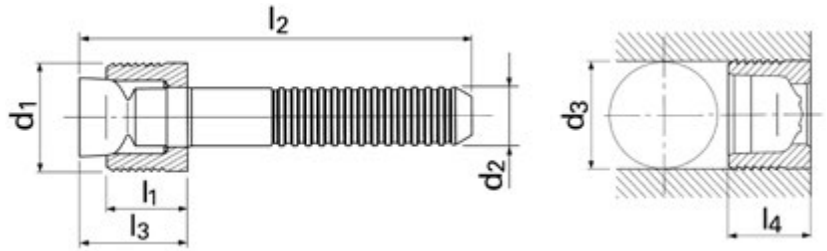

| Part Number | d ₁ | l ₁ | d ₂ | l ₂ | d ₃ +0.12 0 | l ₃ max. | l ₄ max. | Packaging Unit* | Weight in gram/pcs. |
|--------------|----------------|----------------|----------------|----------------|------------------------------|---------------------|---------------------|-----------------|---------------------|
| LK 600-040 | 4.0 | 3.7 | 2.2 | 33 | 4.0 | 6.1 | 4.0 | 1000 | 1.19 |
| LK 600-050 | 5.0 | 4.5 | 2.5 | 36 | 5.0 | 7.4 | 4.8 | 1000 | 1.81 |
| LK 600-060 | 6.0 | 5.0 | 3.2 | 36 | 6.0 | 8.2 | 5.5 | 1000 | 2.95 |
| LK 600-070 | 7.0 | 5.5 | 3.8 | 32 | 7.0 | 9.1 | 5.8 | 500 | 3.70 |
| **LK 600-080 | 8.0 | 6.5 | 4.3 | 34 | 8.0 | 10.8 | 7.0 | 500 | 5.26 |
| **LK 600-100 | 10.0 | 7.0 | 4.9 | 34 | 10.0 | 11.3 | 7.5 | 500 | 7.65 |

Dimensions in millimeters

*Standard pack quantities may vary by sales organization

**Not all items in stock – MOQ and production lead times may apply

PRESSURE PERFORMANCE

| Series LK 600 mm | ① | ② | ③ | ⑤ | ⑥ | ⑦ | ⑧ |
|-----------------------------------|--|-----------------------------------|--|------------------------------------|--|--|--|
| | ETG-100 / 44SMn28 / AISI 1144 | C15Pb / 1.0403 ~ SAE 1015 (10L15) | EN 1563: GJS-600-3 / ASTM A536: 80-60-03 | EN 1561: GJL-250 / ASTM A48: NO.35 | AlCu4Mg1 / EN AW-2024-T3 / AA: 2024 T4/T6* | AlMgSiPb / EN AW-6012-T6 / AA: 6012-T6 | G-AISI7Mg / EN-AC-42100 / ASTM/UNS: A356 |
| Base Material of the Installation | | | | | | | |
| Ø 4 – 10 | 180 bar / 2600 psi 60 bar / 850 psi | | | | | | |

Proof Pressure Test - ⑥

Max. Allowable Working Pressure = Nominal Pressure

*SFC KOENIG's North American Engineering Department utilizes 2024-T4/T6 as a test base material.