

KOENIG EXPANDER® SEALING PLUGS

Series CV 588

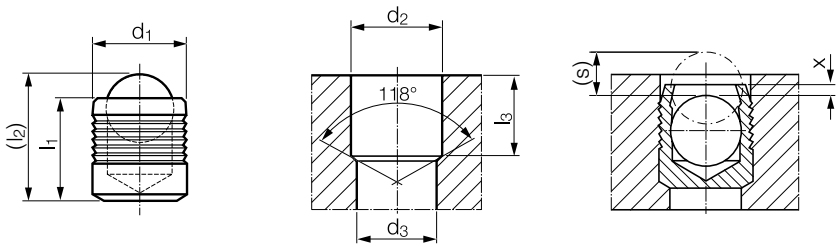

Material:
 Sleeve: Stainless Steel (316) ASTM A580,
 Passivate, QQ-P-35C
 Ball: Stainless Steel, AISI 316,
 Wax Film Lubrication (Diameter Dependant)

Part Number	d ₁	l ₁	(l ₂) ~ Ref.	d ₂ +0.1 0	d ₃ max	l ₃ min.	x ±0.1	(s) ~ Ref.	Packaging Unit*	Weight in gram/pcs.
CV 588-040	4.0	4.00	5.2	4.0	3.3	3.8	0.2	1.4	1000	0.36
CV 588-050	5.0	5.50	7.0	5.0	4.3	5.3	0.2	1.9	1000	0.76
CV 588-060	6.0	6.50	8.6	6.0	5.3	6.3	0.2	2.3	1000	1.28
CV 588-070	7.0	7.50	10.1	7.0	6.2	7.3	0.2	2.8	1000	2.00
CV 588-080	8.0	8.50	11.7	8.0	7.2	8.3	0.2	3.4	1000	2.96
CV 588-090	9.0	10.00	13.7	9.0	8.2	9.8	0.2	3.7	1000	4.31
CV 588-100	10.0	11.00	15.2	10.0	9.2	10.8	0.2	4.2	500	5.88

Dimensions in millimeters
 *Standard pack quantities may vary by sales organization
 Not all items in stock – MOQ and production lead times may apply

PRESSURE PERFORMANCE

Series CV 588 mm	①	③	④	⑥	⑧
	ETG-100 / 44SMn28 AISI 1144	EN 1563: GJS-600-3 ASTM A536: 80-60-03	EN 1563: GJS-450-10 ASTM A536: 65-45-12	AlCu4Mg1 / EN AW-2024-T3 AA: 2024 T4/T6*	G-AISI7Mg / EN-AC-42100 ASTM/UNS: A356
Base Material of the Installation					
Ø 4 – 9	1000 bar / 14500 psi 350 bar / 5000 psi				
Ø 10	860 bar / 12500 psi 280 bar / 4000 psi				

Proof Pressure Test - ②
Max. Allowable Working Pressure = Nominal Pressure
 *SFC KOENIG's North American Engineering Department utilizes 2024-T4/T6 as a test base material.