

KOENIG EXPANDER® SEALING PLUGS

Series MB 700



Material:

Sleeve: Stainless Steel DIN 1.4305
Ball: Bearing Steel, Heat Treated

Important:

See installation instructions on pages 78–79
Installation requirements on page 73

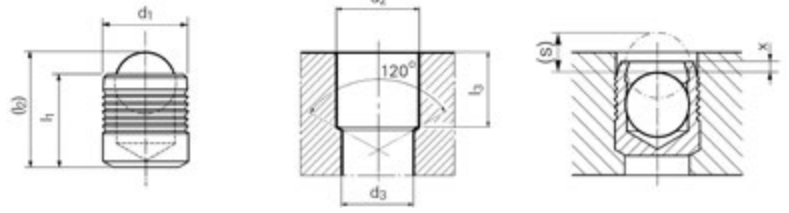

| Part Number | d ₁ | l ₁ | (l ₂) ~ Ref. | d ₂ +0.1 0 | d ₃ max | l ₃ min. | x ±0.2 | (s) ~ Ref. | Packaging Unit* | Weight in gram/pcs. |
|--------------|----------------|----------------|-----------------------------|-----------------------------|--------------------|---------------------|-----------|---------------|--------------------|------------------------|
| MB 700-030 | 3.0 | 3.6 | 4.6 | 3.0 | 2.2 | 3.4 | 0.4 | 1.2 | 1000 | 0.17 |
| MB 700-040 | 4.0 | 4.0 | 5.2 | 4.0 | 3.3 | 3.8 | 0.2 | 1.5 | 2000 | 0.34 |
| MB 700-050 | 5.0 | 5.5 | 7.0 | 5.0 | 4.3 | 5.3 | 0.4 | 1.9 | 2000 | 0.68 |
| MB 700-060 | 6.0 | 6.5 | 8.6 | 6.0 | 5.3 | 6.3 | 0.4 | 2.0 | 2000 | 1.17 |
| MB 700-070 | 7.0 | 7.5 | 10.1 | 7.0 | 6.4 | 7.3 | 0.4 | 3.0 | 1000 | 1.90 |
| MB 700-080 | 8.0 | 8.5 | 11.6 | 8.0 | 7.4 | 8.3 | 0.3 | 3.5 | 1000 | 2.84 |
| MB 700-090 | 9.0 | 10.0 | 13.5 | 9.0 | 8.4 | 9.8 | 0.4 | 4.0 | 500 | 4.00 |
| MB 700-100 | 10.0 | 11.0 | 15.1 | 10.0 | 9.4 | 10.8 | 0.4 | 4.5 | 500 | 5.47 |
| MB 700-120 | 12.0 | 13.0 | 17.8 | 12.0 | 10.6 | 12.8 | 0.4 | 5.5 | 250 | 9.31 |
| **MB 700-140 | 14.0 | 15.0 | 20.4 | 14.0 | 12.7 | 14.5 | 0.4 | 6.35 | 250 | 14.72 |
| **MB 700-160 | 16.0 | 17.0 | 23.4 | 16.0 | 14.7 | 16.5 | 0.6 | 7.0 | 100 | 22.00 |
| **MB 700-180 | 18.0 | 19.0 | 26.3 | 18.0 | 16.7 | 18.5 | 0.6 | 8.0 | 100 | 31.34 |
| **MB 700-200 | 20.0 | 22.0 | 30.0 | 20.0 | 18.7 | 21.5 | 0.8 | 9.0 | 100 | 44.24 |
| **MB 700-220 | 22.0 | 25.0 | 34.0 | 22.0 | 20.7 | 24.5 | 0.8 | 10.0 | 50 | 58.61 |

Dimensions in millimeters

*Standard pack quantities may vary by sales organization

**Not all items in stock – MOQ and production lead times may apply

PRESSURE PERFORMANCE

| Series MB 700 mm | ① | ② | ③ | ⑤ | ⑥ | ⑦ | ⑧ |
|-----------------------------------|---|---|---|---|---|--|---|
| | ETG-100 / 44SMn28 AISI 1144 | C15Pb / 1.0403 ~ SAE 1015 (10L15) | EN 1563: GJS-600-3 ASTM A536: 80-60-03 | EN 1561: GJL-250 ASTM A48: NO.35 | AlCu4Mg1 / EN AW-2024-T3 AA: 2024 T4/T6* | AlMgSiPb / EN AW-6012-T6 AA: 6012-T6 | G-AlSi7Mg / EN-AC-42100 ASTM/UNS: A356 |
| Base Material of the Installation | | | | | | | |
| Ø 3 – 10 | 1400 bar / 20300 psi 450 bar / 6500 psi | | | | 1200 bar / 17400 psi 380 bar / 5500 psi | | |
| Ø 12 – 22 | 1150 bar / 16700 psi 350 bar / 5100 psi | | | | 900 bar / 13000 psi 280 bar / 4100 psi | | |

Proof Pressure Test - ②

Max. Allowable Working Pressure = Nominal Pressure

*SFC KOENIG's North American Engineering Department utilizes 2024-T4/T6 as a test base material.